

Skill name
Cabinetmaking
Criteria

| | Criteria | Mark |
|---|-------------------------------------|-------|
| A | Dimensions | 19.00 |
| B | Conforming to drawing | 11.00 |
| C | Face Marking & Joints before gluing | 19.00 |
| D | Joints after gluing | 18.00 |
| E | Fitting and moveable parts | 16.00 |
| F | Surfaces | 12.00 |
| G | Use of Materials | 5.00 |

| Sub Criteria ID | Sub Criteria Name or Description | Aspect Type O = Obj S = Sub J = Judg | Aspect - Description | Judg Score |
|-----------------|----------------------------------|---|---|------------|
| A1 | Total height | | | |
| | | <input type="radio"/> | Measure at left front leg using gauge template. | |
| | | <input type="radio"/> | Measure at right back leg using gauge template. | |
| A2 | Total height of carcass | | | |
| | | <input type="radio"/> | Measure at right back carcass using gauge template. | |
| | | <input type="radio"/> | Measure at left front carcass using gauge template. | |
| A3 | Total Width of carcass | | | |
| | | <input type="radio"/> | Measure at lower front between legs using gauge template. | |
| | | <input type="radio"/> | Measure at top front between legs using gauge template. | |
| A4 | Total Depth of carcass | | | |
| | | <input type="radio"/> | Measure at top left using gauge template. | |
| | | <input type="radio"/> | Measure at top right end using gauge template. | |
| A5 | Distance of shelf in carcass | | | |
| | | <input type="radio"/> | Measure at between bottom to shelf using gauge template. | |

| A6 | Total measure of top | | <input type="radio"/> Measure at front side length using gauge template. <input type="radio"/> Measure at left right width using gauge template. | |
|-----------------|---------------------------------------|---|---|------------|
| A7 | Distance between top to carcass | | <input type="radio"/> Measure at left side between top to carcass using gauge template. <input type="radio"/> Measure at right side between top to carcass using gauge template. | |
| A8 | Distance between legs | | <input type="radio"/> Measure at left top width between legs using gauge template. <input type="radio"/> Measure at right bottom width between legs using gauge template. | |
| A9 | Distance between end legs and carcass | | <input type="radio"/> Measure at left between end legs and bottom. <input type="radio"/> Measure at right end using gauge template. | |
| A10 | Measure of veneer design | | <input type="radio"/> Measure at centre of Veneer | |
| A11 | Measure of handle pull in drawer | | <input type="radio"/> Measure at length down of handle pull. | |
| Sub Criteria ID | Sub Criteria Name or Description | Aspect Type O = Obj S = Sub J = Judg | Aspect - Description | Judg Score |
| B1 | Veneer in top | | <input type="radio"/> The grain direction is correct <input type="radio"/> The banding is attached | |
| B2 | Drawer | | <input type="radio"/> The left runner in the drawer is attached <input type="radio"/> The right runner in the drawer is attached <input type="radio"/> The distance between bottom at end edges of drawer is 8 mm <input type="radio"/> The angle on the drawer front exists | |
| B3 | Doors | | <input type="radio"/> Handle pull is attached <input type="radio"/> The cross in left door is attached <input type="radio"/> The cross in right door is attached | |
| B4 | Top | | <input type="radio"/> The chamfer in the top is 8 x 8 mm <input type="radio"/> The distance between legs and under top in front and back is 40 | |
| B5 | Carcass | | | |

| B6 | Errors (mistakes / not like the drawing) | <ul style="list-style-type: none"> O The shelf is attached O The distance between back panel and back eches is 10 mm O The legs have proper tapers on them all. O A visible error recorded by three or more judges O A visible error recorded by three or more judges O A visible error recorded by three or more judges | | |
|-----------------|--|--|----------------------|------------|
| Sub Criteria ID | Sub Criteria Name or Description | Aspect Type O = Obj S = Sub J = Judg | Aspect - Description | Judg Score |
| C1 | Face marking of drawer | <ul style="list-style-type: none"> O Markings are correct O Markings are clean and neat | | |
| C2 | Face marking of Legs and Doors | <ul style="list-style-type: none"> O Markings appear on both left and right sides O Markings are correct in left door O Markings are correct in right door | | |
| C3 | 4 Drawer dovetails joints before gluing | <ul style="list-style-type: none"> S Front dovetails Inside and outside of joints are clean and straight S Back dovetails Inside and outside of joints are clean and straight | | |
| C4 | 4 Leg and top mortise joints before gluing | <ul style="list-style-type: none"> S Inside and outside of joints are clean and straight and correct. | | |
| C5 | 2 doors mortise joints before gluing | <ul style="list-style-type: none"> S Left door Inside and outside of joints are clean and straight and c S Right door Inside and outside of joints are clean and straight and | | |
| C6 | 2 crosses of door joints before gluing | <ul style="list-style-type: none"> S Left and right cross outside of joints are clean and correct | | |
| C7 | Top joint before gluing | <ul style="list-style-type: none"> S The biscuits in lenth top are accuracy and correct. S The biscuits in width top are accuracy and correct. | | |

| Sub Criteria ID | Sub Criteria Name or Description | Aspect Type O = Obj S = Sub J = Judg | Aspect - Description | Judg Score |
|-----------------|--|---|---|------------|
| D1 | Drawer Dovetail joints after gluing | S | Front Joints are tight, flush and correct. | |
| D2 | Leg and top joints after gluing | S | Back Joints are tight, flush and correct. | |
| D3 | Door joints after gluing | S | Front Joints are tight, flush and correct. | |
| D4 | Carcase (cabinet) joints after gluing | S | Back Joints are tight, flush and correct. | |
| D5 | Top Veneer and banding joints after gluing | S | Left door Joints are tight, flush and correct. | |
| D6 | Top Miters | S | Right door joints are tight, flush and correct. | |
| | | S | Joints are tight, flush and correct. | |
| | | S | Joints are tight and correct. | |
| | | S | Joints are tight and correct | |
| Sub Criteria ID | Sub Criteria Name or Description | Aspect Type O = Obj S = Sub J = Judg | Aspect - Description | Judg Score |
| E1 | Hinge Insert | O | 2 Left Hinge is inset and screwed | |
| | | O | 2 Right Hinge is inset and screwed | |
| | | O | 2 Left Hinge is flush | |
| | | O | 2 Right Hinge is flush | |
| | | O | 2 Left Hinge has no gap around it (+/- 0.9mm) | |
| | | O | 2 Right Hinge has no gap around it (+/- 0.9mm) | |
| E2 | Drawer finger pull | O | Finger pull is correct | |
| E3 | Door finger pull and magnetic close | O | Finger pull is correct | |
| | | O | Magnetic close is screwed in place | |

| E4 | Drawer rails | O | Drawer rails are screwed in place | |
|-----------------|--|---|---|------------|
| E5 | Doors operation | S | Left Door functions properly | |
| | | S | Right Door functions properly | |
| E6 | Drawer operation | S | Drawer slides front to back properly. (One finger push) | |
| | | S | Fit of closed drawer. (gap / flush / etc) | |
| Sub Criteria ID | Sub Criteria Name or Description | Aspect Type O = Obj S = Sub J = Judg | Aspect - Description | Judg Score |
| F1 | Sanding of legs | O | All surfaces have been sanded | |
| | | O | All edges have been broken (softened) | |
| F2 | Sanding of Carcase | O | Some surfaces have been sanded | |
| | | O | All surfaces have been sanded | |
| | | O | All edges have been broken (softened) | |
| F3 | Sanding of Drawer | O | Some surfaces have been sanded | |
| | | O | All surfaces have been sanded | |
| | | O | All edges have been broken (softened) | |
| F4 | Sanding of Top (Veneer, banding & edges) | O | Some surfaces have been sanded | |
| | | O | All surfaces have been sanded | |
| | | O | Cross grained scratches do not visible | |
| F5 | Sanding Quality of Outside | S | Quality of sanding of Top and Legs to proper grit and ready for a | |
| | | S | Quality of sanding of (Carcase, Drawer, Doors and Back) outside | |
| F6 | Sanding Quality of Inside | S | Quality of entire unit sanded inside (including the drawe) to prope | |

| Sub Criteria ID | Sub Criteria Name or Description | Aspect Type O = Obj S = Sub J = Judg | Aspect - Description | Judg Score |
|-----------------------|-------------------------------------|--|---|---------------|
| G1 | Part replacement | <input type="radio"/> <input type="radio"/> <input type="radio"/> <input type="radio"/> | No replacement piece required - First Part No replacement piece required- Second Part No replacement piece required- Third Part No replacement piece required- Fourth Part | |

| Extra Aspect Description (Obj or Subj) OR Judgement Score Description (Judg only) | | Requirement or Nominal Size (Obj Only) | WSSS Section | Max Mark |
|---|---------------|--|-----------------|-------------|
| Yes = 1 point | No = 0 points | 764+/- 0.9mm | 6 | 1.00 |
| Yes = 1 point | No = 0 points | 764+/- 0.9mm | 6 | 1.00 |
| Yes = 1 point | No = 0 points | 540+/- 0.9mm | 6 | 1.00 |
| Yes = 1 point | No = 0 points | 540+/- 0.9mm | 6 | 1.00 |
| Yes = 1 point | No = 0 points | 580+/- 0.9mm | 6 | 1.00 |
| Yes = 1 point | No = 0 points | 580+/- 0.9mm | 6 | 1.00 |
| Yes = 1 point | No = 0 points | 310+/- 0.9mm | 6 | 1.00 |
| Yes = 1 point | No = 0 points | 310+/- 0.9mm | 6 | 1.00 |
| Yes = 1 point | No = 0 points | 184+/- 0.9mm | 6 | 1.00 |

Criterion
A

Total
Mark

19.00

| Yes = 1 point | No = 0 points | 710+/- 0.9mm | 6 | 1.00 |
|---|---------------|--|-----------------|-------------|
| Yes = 1 point | No = 0 points | 360+/- 0.9mm | 6 | 1.00 |
| Yes = 1 point | No = 0 points | 50+/- 0.9mm | 6 | 1.00 |
| Yes = 1 point | No = 0 points | 50+/- 0.9mm | 6 | 1.00 |
| Yes = 1 point | No = 0 points | 220+/- 0.9mm | 6 | 1.00 |
| Yes = 1 point | No = 0 points | 220+/- 0.9mm | 6 | 1.00 |
| Yes = 1 point | No = 0 points | 15+/- 0.9mm | 6 | 1.00 |
| Yes = 1 point | No = 0 points | 15+/- 0.9mm | 6 | 1.00 |
| Yes = 1 point | No = 0 points | 355+/- 0.9mm | 6 | 1.00 |
| Yes = 1 point | No = 0 points | 296+/- 0.9mm | 6 | 1.00 |
| Extra Aspect Description (Obj or Subj) OR Judgement Score Description (Judg only) | | Requirement or Nominal Size (Obj Only) | WSSS Section | Max Mark |
| Yes = 0.5 points | No = 0 points | Yes / No | 5 | 0.50 |
| Yes = 0.5 points | No = 0 points | Yes / No | 5 | 0.50 |
| Yes = 0.5 points | No = 0 points | Yes / No | 4 | 0.50 |
| Yes = 0.5 points | No = 0 points | Yes / No | 4 | 0.50 |
| Yes = 0.5 points | No = 0 points | Yes / No | 4 | 0.50 |
| Yes = 0.5 points | No = 0 points | Yes / No | 4 | 1.00 |
| Yes = 0.5 points | No = 0 points | Yes / No | 4 | 0.50 |
| Yes = 0.5 points | No = 0 points | Yes / No | 4 | 0.50 |
| Yes = 0.5 points | No = 0 points | yes / No | 4 | 0.50 |
| Yes = 0.5 points | No = 0 points | Yes / No | 4 | 0.50 |
| Yes = 0.5 points | No = 0 points | Yes / No | 4 | 0.50 |

Criterion B Total Mark 11.00

| | | | | |
|------------------|---------------|----------|---|------|
| Yes = 0.5 points | No = 0 points | yes / No | 4 | 0.50 |
| Yes = 0.5 points | No = 0 points | yes / No | 4 | 0.50 |
| Yes = 0.5 points | No = 0 points | yes / No | 4 | 1.00 |
| Yes = 1 point | No = 0 points | Yes / No | 2 | 1.00 |
| Yes = 1 point | No = 0 points | Yes / No | 2 | 1.00 |
| Yes = 1 point | No = 0 points | Yes / No | 2 | 1.00 |

| Extra Aspect Description (Obj or Subj) OR Judgement Score Description (Judg only) | Requirement or Nominal Size (Obj Only) | WSSS Section | Max Mark | |
|---|--|-----------------|-------------|------|
| Yes = 1 points | No = 0 points | Yes / No | 4 | 1.00 |
| Yes = 1 points | No = 0 points | Yes / No | 4 | 1.00 |
| Yes = 1 points | No = 0 points | Yes / No | 4 | 1.00 |
| Yes = 1 points | No = 0 points | Yes / No | 4 | 0.50 |
| Yes = 1 points | No = 0 points | Yes / No | 4 | 0.50 |
| Fit of joint is with hand pressure | | | 5 | 2.00 |
| Fit of joint is with hand pressure | | | 5 | 2.00 |
| Fit of joint is with hand pressure | | | 5 | 2.00 |
| Fit of joint is with hand pressure | | | 5 | 2.00 |
| Fit of joint is with hand pressure | | | 5 | 2.00 |
| Fit of joint is with hand pressure | | | 5 | 2.00 |
| | | | 5 | 1.50 |
| | | | 5 | 1.50 |

Criterion C Total Mark 19.00

| Extra Aspect Description (Obj or Subj) OR Judgement Score Description (Judg only) | Requirement or Nominal Size (Obj Only) | WSSS Section | Max Mark |
|---|--|-----------------|-------------|
| | | 6 | 2.00 |
| | | 6 | 2.00 |
| | | 6 | 2.00 |
| | | 6 | 2.00 |
| | | 5 | 2.00 |
| | | 5 | 2.00 |
| | | 5 | 2.00 |
| | | 5 | 2.00 |
| | | 5 | 2.00 |
| | | 5 | 2.00 |
| Extra Aspect Description (Obj or Subj) OR Judgement Score Description (Judg only) | Requirement or Nominal Size (Obj Only) | WSSS Section | Max Mark |
| Yes = 0.5 points No = 0 points | Yes / No | 4 | 0.50 |
| Yes = 0.5 points No = 0 points | Yes / No | 4 | 0.50 |
| Yes = 0.5 points No = 0 points | Yes / No | 4 | 0.50 |
| Yes = 0.5 points No = 0 points | Yes / No | 4 | 0.50 |
| Yes = 0.5 points No = 0 points | Yes / No | 4 | 0.50 |
| Yes = 0.5 points No = 0 points | Yes / No | 4 | 0.50 |
| Yes = 1 points No = 0 points | Yes / No | 3 | 2.00 |
| Yes = 1 points No = 0 points | Yes / No | 3 | 2.00 |
| Yes = 1 points No = 0 points | Yes / No | 3 | 1.00 |

Criterion D **Total Mark** **18.00**

Criterion E **Total Mark** **16.00**

| Yes = 1 points | No = 0 points | Yes / No | 4 | 1.00 |
|---|---------------|--|-----------------|-------------|
| | | | 7 | 1.50 |
| | | | 7 | 1.50 |
| | | | 7 | 2.00 |
| | | | 7 | 2.00 |
| Extra Aspect Description (Obj or Subj) OR Judgement Score Description (Judg only) | | Requirement or Nominal Size (Obj Only) | WSSS Section | Max Mark |
| Yes = 0.5 points | No = 0 points | Yes / No | 7 | 0.50 |
| Yes = 0.5 points | No = 0 points | Yes / No | 7 | 0.50 |
| Yes = 0.5 points | No = 0 points | Yes / No | 7 | 0.50 |
| Yes = 0.5 points | No = 0 points | Yes / No | 7 | 0.50 |
| Yes = 0.5 points | No = 0 points | Yes / No | 7 | 0.50 |
| Yes = 0.5 points | No = 0 points | Yes / No | 7 | 0.50 |
| Yes = 0.5 points | No = 0 points | Yes / No | 7 | 0.50 |
| Yes = 0.5 points | No = 0 points | Yes / No | 7 | 0.50 |
| Yes = 0.5 points | No = 0 points | Yes / No | 7 | 1.00 |
| | | | 1 | 2.00 |
| | | | 1 | 2.00 |
| | | | 1 | 2.00 |

Criterion F Total Mark 12.00

| Extra Aspect Description (Obj or Subj) OR Judgement Score Description (Judg only) | | Requirement or Nominal Size (Obj Only) | WSSS Section | Max Mark |
|---|---------------|--|-----------------|-------------|
| Yes = 2 points | No = 0 points | Yes / No | 1 | 2.00 |
| Yes = 1 points | No = 0 points | Yes / No | 1 | 1.00 |
| Yes = 1 points | No = 0 points | Yes / No | 1 | 1.00 |
| Yes = 1 points | No = 0 points | Yes / No | 1 | 1.00 |

Criterion G Total Mark 5.00

Competition Total Mark 100.00

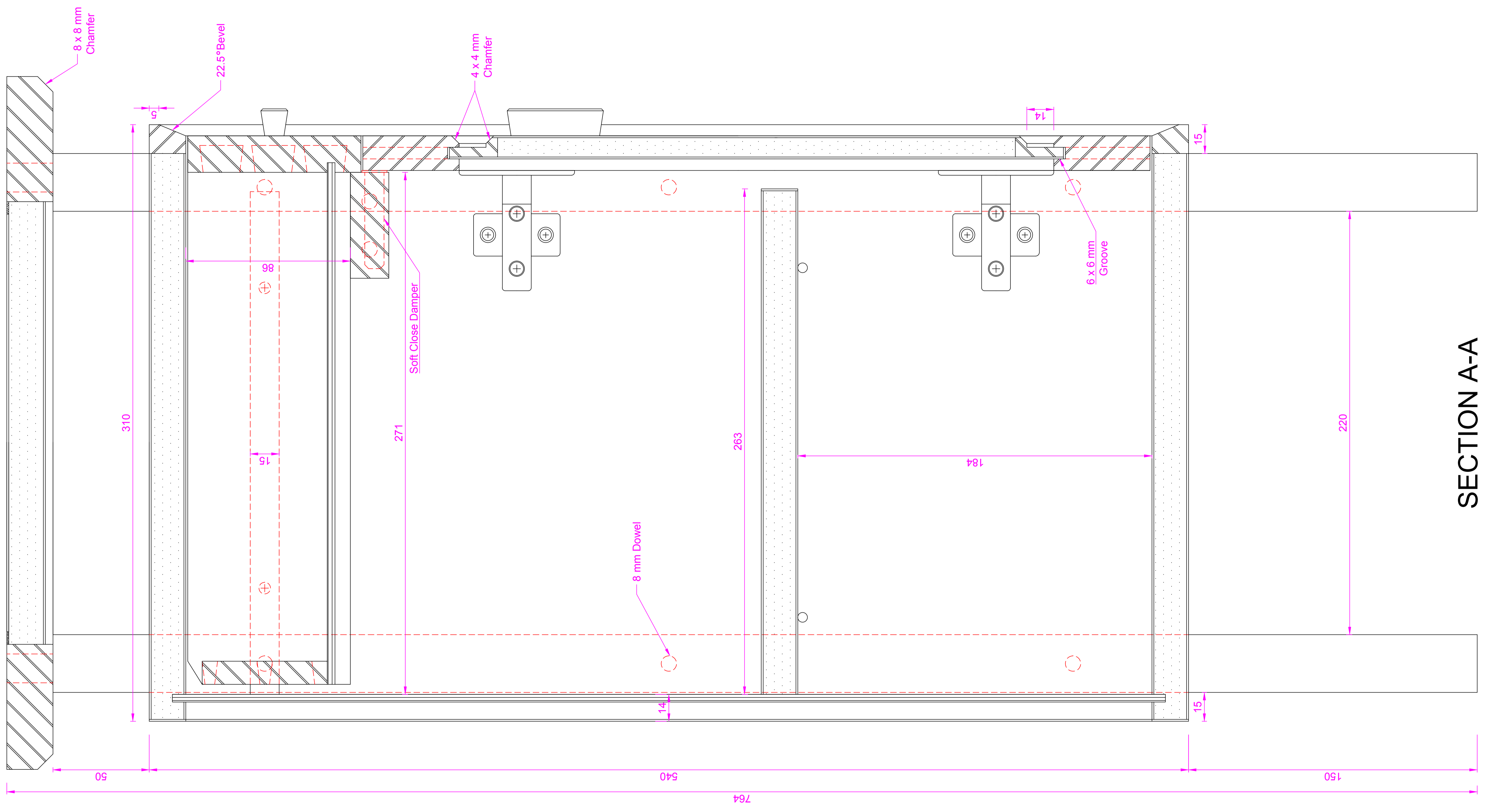

SECTION A-A

Test Project for the 43rd WorldSkills
 Competition in Sao Paulo, Brazil 2015.
 Copyright © 2015 WorldSkills International.
 All Rights Reserved.



| | | | | |
|--------------------------------------|----------------|-----------|---------------|--------------|
| Skill: Cabinetmaking Trade No. 24 | | | Drawing No: 2 | |
| Scale: 1:1 | Date: 24/06/13 | Paper: A1 | Rev: 1 | Page: 1 of 2 |
| Drawn / Design by: Declan Barrett IE | | | Appd: | Sign: |
| Description: Cabinet | | | | |

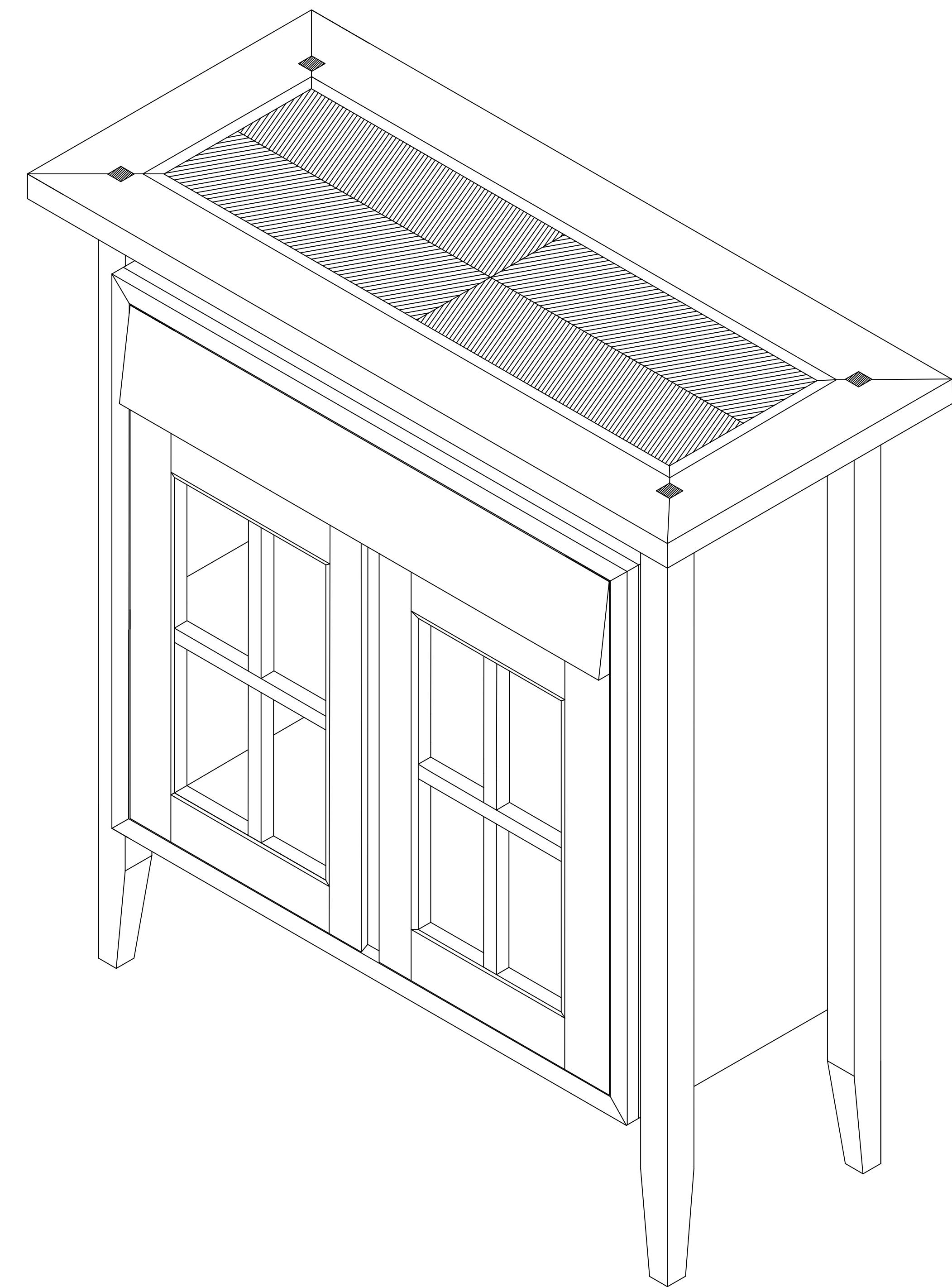
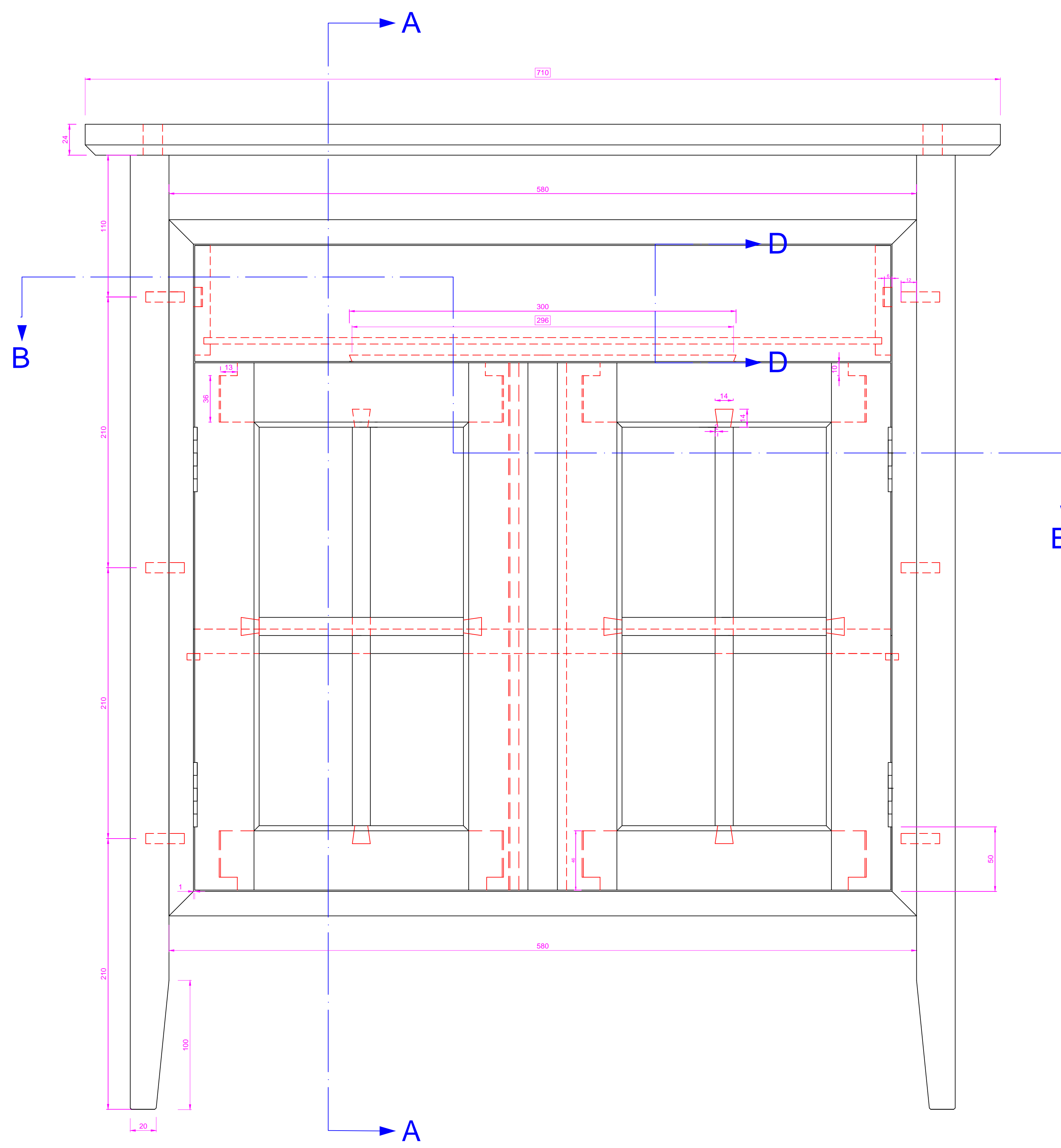

Test Project for the 43rd WorldSkills
 Competition in São Paulo, Brazil 2015.
 Copyright © 2015 WorldSkills International.
 All Rights Reserved.



| | | | |
|--------------------------------------|----------------|--------------------------------|--------|
| Skill: cabinetmaking trade 24 | | Drawing No: WSC2015_TPIE_A1_EN | |
| Scale: 1:2 | Date: 24.06.13 | Paper: A1 | Rev: 1 |
| Drawn / Design by: Declan Barrett IE | | Page: 1 OF 3 | |
| Description: Cabinet | | Appd: Jason AU | Sign: |

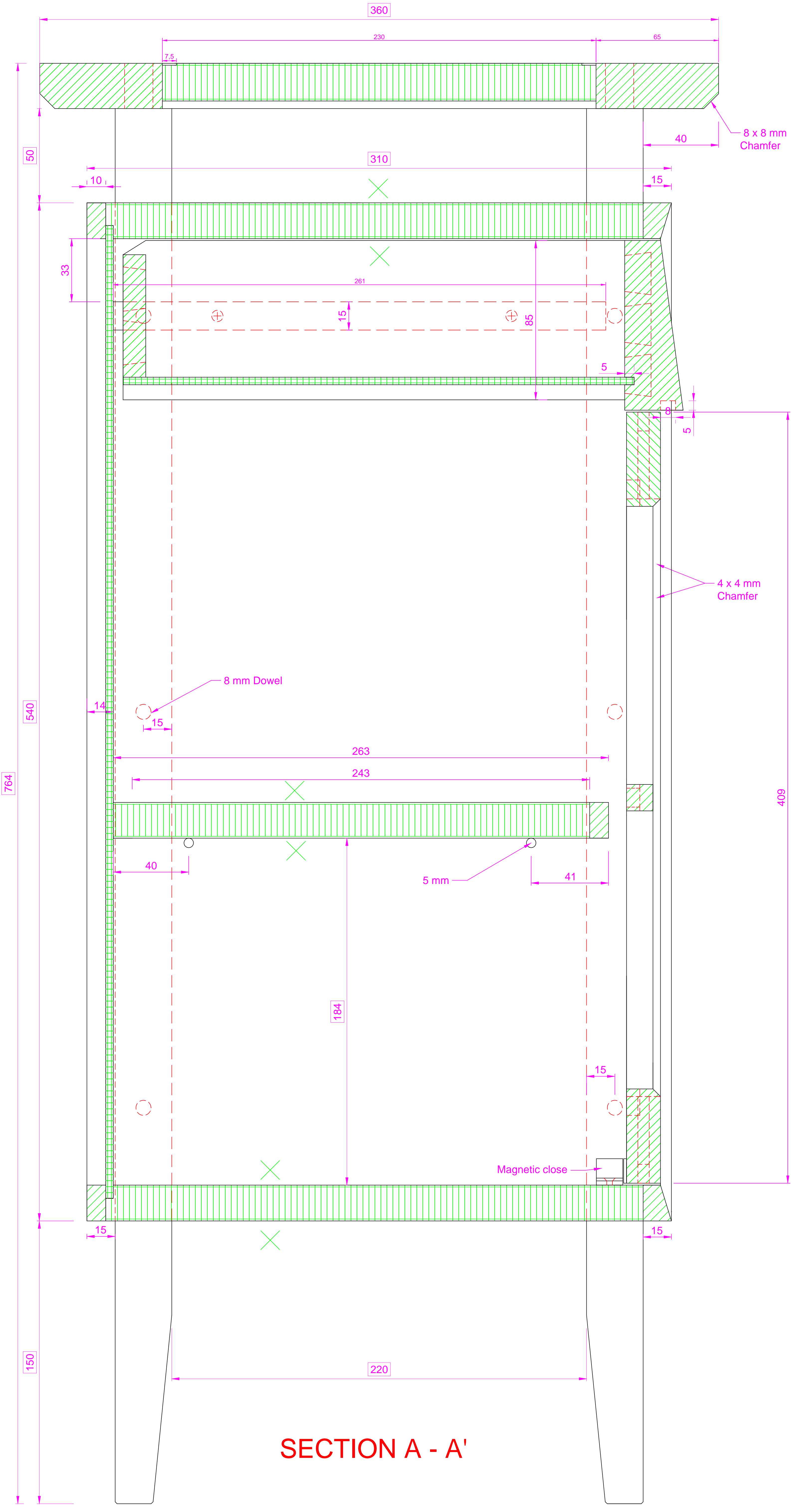

SECTION A - A'

Test Project for the 43rd WorldSkills
Competition in São Paulo, Brazil 2015.
Copyright © 2015 WorldSkills International.
All Rights Reserved.

Skill: cabinetmaking trade 24
Scale: 1:1
Date: 24.06.13
Paper: A1
Drawing No.: WSC2015_TPIE_A1_EN
Rev.: 1
Page: 3 OF 3
Appr.: Jason AU
Sign:

WorldSkills International

TEST PROJECT CABINETMAKING

WSC2015_TP24_actual

Submitted by:

Name: Declan Barrett

Member country/region: Ireland





CONTENTS

This Test Project proposal consists of the following documentation/files:

1. WSC2015_TP24_IE_EN.doc (Instructions and Materials list)
2. WSC2015_TP24_IE_01_EN.dwg (AutoCAD file of drawing 1)
3. WSC2015_TP24_IE_02_EN.dwg (AutoCAD file of drawing 2)
4. WSC2015_TP24_IE_01_EN.pdf (pdf version of drawing 01)
5. WSC2015_TP24_IE_02_EN.pdf (pdf version of drawing 02)
6. WSC2015_TP24_IE_01.jpg (Image 01)
7. WSC2015_TP24_IE_02.jpg (Image 02)
8. WSC2015_TP24_IE_03.jpg (Image 03)

INTRODUCTION

The Drawing represents a free standing cabinet. The unit consists of two hinged doors and a drawer.

INSTRUCTIONS TO THE COMPETITOR

The cabinet is to be constructed with the aid of machinery except for dovetails which must be cut by hand.

The unit consists of a carcass which is mitred on all corners these corners will be jointed with biscuit joints the quantity and position of the biscuits will be your own judgement.

The carcass has a shelf which is supported on shelf supports.

The carcass is supported on four legs which are shaped and are connected to the carcass with dowels. (Leg sections are 30 x 30 mm square, an off cut is glued to the bottom of the leg to allow for shaping).

The top of the unit is a veneered panel with a solid wood edge this solid wood edge is mitred on the corners and is biscuit jointed to the panel.

The legs and top are jointed using mortise and tennon joinery.

The unit has a drawer made with traditional construction.

The cabinet door is made with bridle joints on the top and mitred bridle joints on the bottom corners of the cabinet, it has a raised panel and is hung using inset cabinet blum hinges.

The work should be carried out in a safe manner and should not exceed the maximum working time of 22 hours.



LIST OF MATERIALS REQUIRED

| QTY | COMPONENT | LENGTH | WIDTH | THICKNESS | MATERIAL |
|-----------|----------------------|--------|-------|-----------|---------------|
| Leg Frame | | | | | |
| 4 | Legs | 920 | 30 | 30 | Walnut |
| Carcass | | | | | |
| 2 | Gables | 560 | 295 | 18 | Maple MDF |
| 2 | Top and Bottom | 600 | 295 | 18 | Maple MDF |
| 1 | Shelf | 580 | 260 | 18 | Maple MDF |
| 1 | Rail | 580 | 55 | 20 | Maple MDF |
| 1 | Back | 540 | 580 | 4 | Birch Plywood |
| 2 | Lippings | 560 | 19.5 | 15 | Maple |
| 2 | Lippings | 600 | 19.5 | 15 | Maple |
| Top | | | | | |
| 2 | Sides | 400 | 65 | 20 | Walnut |
| 2 | Front and Back Rails | 740 | 65 | 20 | Walnut |
| 1 | Top | 580 | 230 | 18 | MDF |
| 4 | Veneers | 290 | 120 | 1 | Maple |
| 1 | Veneer | 590 | 240 | 1 | Maple |
| 1 | Banding | 1700 | 6 | 1.5 | Walnut |
| Drawer | | | | | |
| 1 | Front | 580 | 90 | 19 | Maple |
| 2 | Sides | 290 | 90 | 12 | Maple |
| 1 | Back | 580 | 65 | 12 | Maple |
| 1 | Base | 580 | 285 | 4 | Birch Ply |



| QTY | COMPONENT | LENGTH | WIDTH | THICKNESS | MATERIAL |
|----------------------|----------------------|---|-------|-----------|----------|
| Doors | | | | | |
| 4 | Stiles | 450 | 50 | 18 | Maple |
| 4 | Top and Bottom Rails | 300 | 50 | 18 | Maple |
| 2 | Panels | 269* | 130* | 12 | MDF |
| 4 | Lippings | 400 | 25 | 12 | Maple |
| 4 | Veneers | 330 | 190 | 1 | Maple |
| Additional Materials | | | | | |
| 4 | Hinges | Hafele Cat. No. 322.15.542 (Plates) Cat. No. 322.85.750 | | | |
| 12 | Dowels | 30 x 8mm | | | |
| 24 | Biscuits | Size 10 | | | |
| 2 | Soft Close Dampers | Hafele Cat. No. 356.33.509 | | | |
| 3 | Handles | | | | |
| 16 | Screws for Hinges | 3.5 x 15 | | | |
| 4 | Shelf supports | 5mm Diameter | | | |

CABINET DETAILS



Finished cabinet

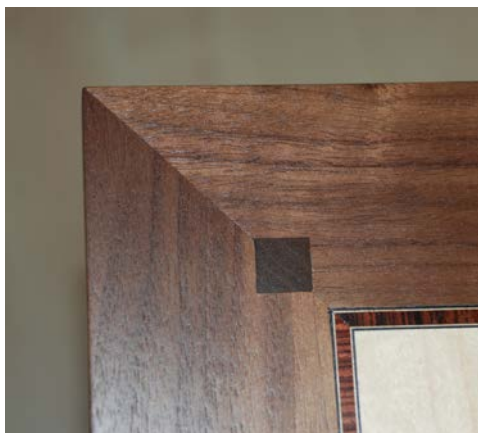

Leg to top detail

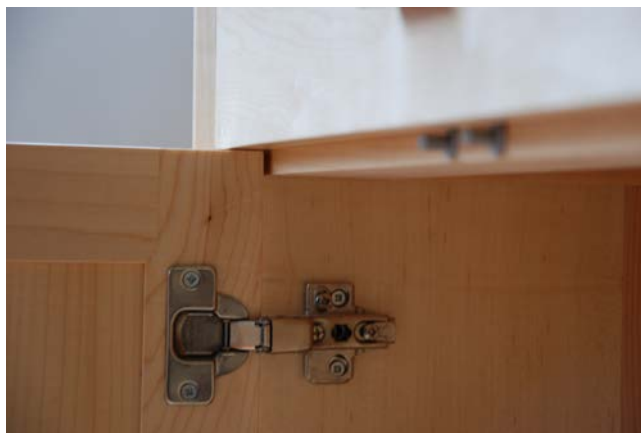

Hinge detail

MARKING SCHEME

| MAIN DIMENSIONS | |
|----------------------------------|---|
| Top Length | 2 |
| Top Depth | 2 |
| Unit Height | 4 |
| Carcass Width | 2 |
| SECONDARY DIMENSIONS | |
| Drawer Depth | 2 |
| Carcass Height | 2 |
| Distance between Top and carcass | 2 |
| Shelf Height | 2 |
| FACE MARKING AND SETTING OUT | |
| Doors | 3 |
| Drawer | 3 |
| JOINTS BEFORE GLUING | |
| Doors | 8 |
| Drawer | 4 |
| Leg and Top Joints | 4 |



| | |
|---------|---|
| Carcass | 2 |
|---------|---|

JOINTS AFTER GLUING

| | |
|--------------------|---|
| Doors | 8 |
| Drawer | 4 |
| Leg and Top Joints | 4 |
| Carcass | 2 |

FITTINGS AND MOVEABLE PARTS

| | |
|------------------------------|---|
| Doors hinge fit and function | 4 |
| Handles | 1 |
| Drawer fit and function | 4 |
| Soft Close Damper | 1 |

SURFACES AND CONFORMING TO DRAWING

| | |
|-----------------------|---|
| Solid wood finish | 6 |
| Veneer finish | 6 |
| Excess glue removed | 1 |
| Veneer Pattern | 4 |
| Conforming to drawing | 4 |
| Shaping of legs | 2 |
| Fitting of Banding | 2 |

USE OF MATERIAL

| | |
|-----------------|---|
| Use of Material | 5 |
|-----------------|---|

TOTAL 100

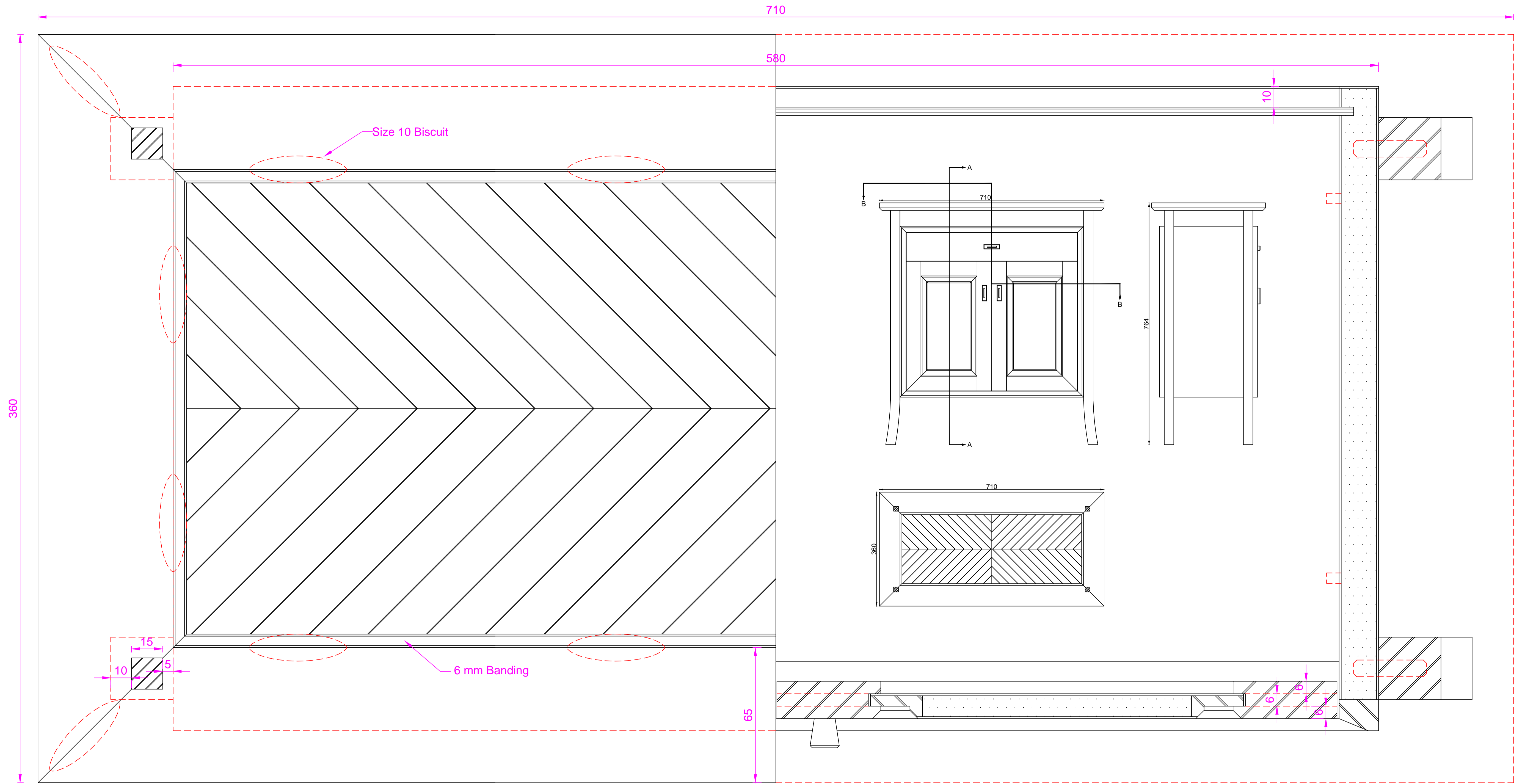

SECTION B-B

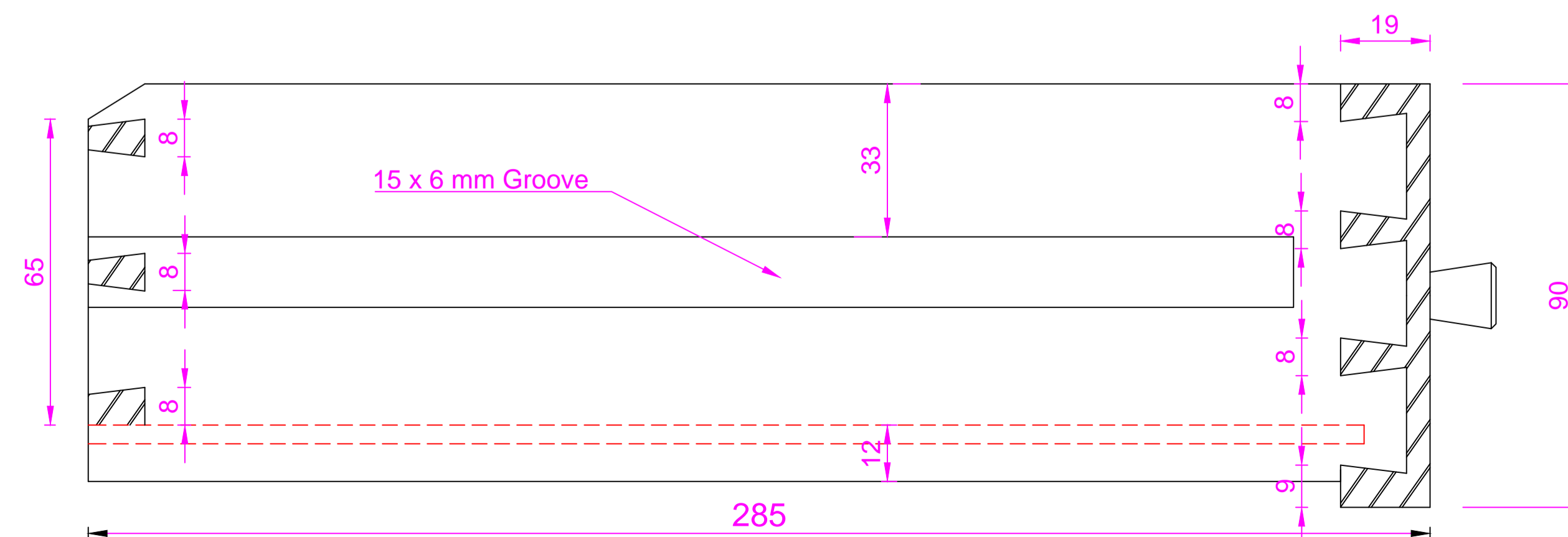

DRAWER DETAIL

Test Project for the 43rd WorldSkills
 Competition in Sao Paulo, Brazil 2015.
 Copyright © 2015 WorldSkills International.
 All Rights Reserved.



| | | | |
|--------------------------------------|----------------|---------------|--------------|
| Skill: Cabinetmaking Trade No. 24 | | Drawing No: 1 | |
| Scale: 1:1 | Date: 24/06/13 | Paper: A1 | |
| Drawn / Design by: Declan Barrett IE | | Rev: 1 | Page: 1 of 2 |
| Description: Cabinet | | Appd: | Sign: |